



Relocatability
without material loss



Perfection
in detail



Fulfilment of the
highest constructional
requirements



Optimised
room acoustics



Versatility
and compatibility



System-integrated
solutions



feco. The Partition Wall.
A system-based successful partnership.

The feco system.

Partition walls create spaces.

feco partition wall systems have a clear design language and their design has a decisive influence on the internal impact of a building. They create spatial solutions that connect with the given architecture. The fact that using our feco system you can react flexibly to changes in your company is another big plus. New spatial requirements can be implemented without material loss – if necessary during ongoing business operations.

But that's not all: feco also offers the highest level of technical perfection, be it with respect to the fulfilment of demanding noise and fire protection requirements or the low maintenance requirements. Our clamping system provides first-class sound insulation and excellent statics. With feco all you need is one thing – space.

Well thought-out structures with simultaneous fulfilment of the highest constructional requirements.



With feco partition walls change is also taken into account. If structures change, the partitions simply change with them.

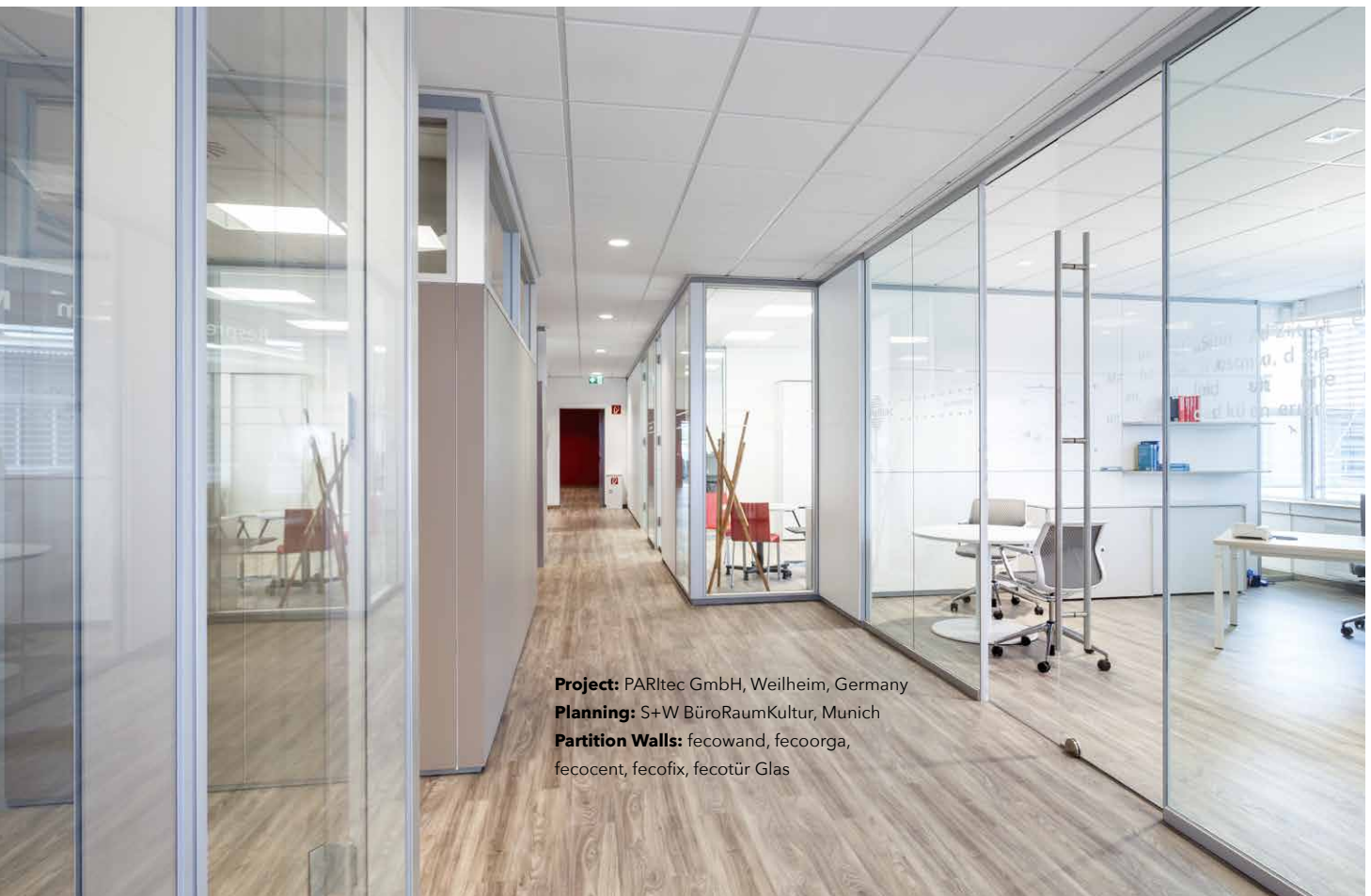
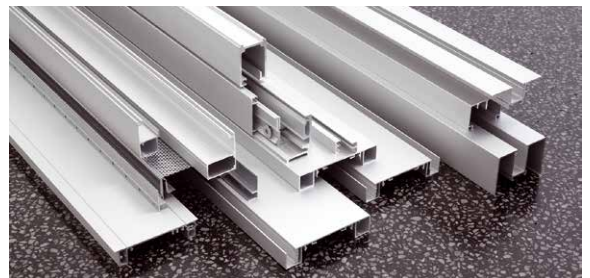

Project: PARItec GmbH, Weilheim, Germany
Planning: S+W BüroRaumKultur, Munich
Partition Walls: fecowand, fecoorga, fecocent, fecofix, fecotür Glas

feco partners worldwide.

Unlimited quality.

The feco partition wall system is at home all over the world. Our philosophy of sharing know-how with licensed partners and thus taking country-specific requirements into account guarantees cost-effectiveness and optimal local service. This is because with the unique feco system feco partners define their individual production depth. This enables them to determine the added value of their company themselves and to benefit from our support in the form of technical documentation, test certificates and training.



Project: Misys Romania, Bucharest
Planning: COS, Bucharest, Romania
Partition Walls: fecoplan, fecotür Glas

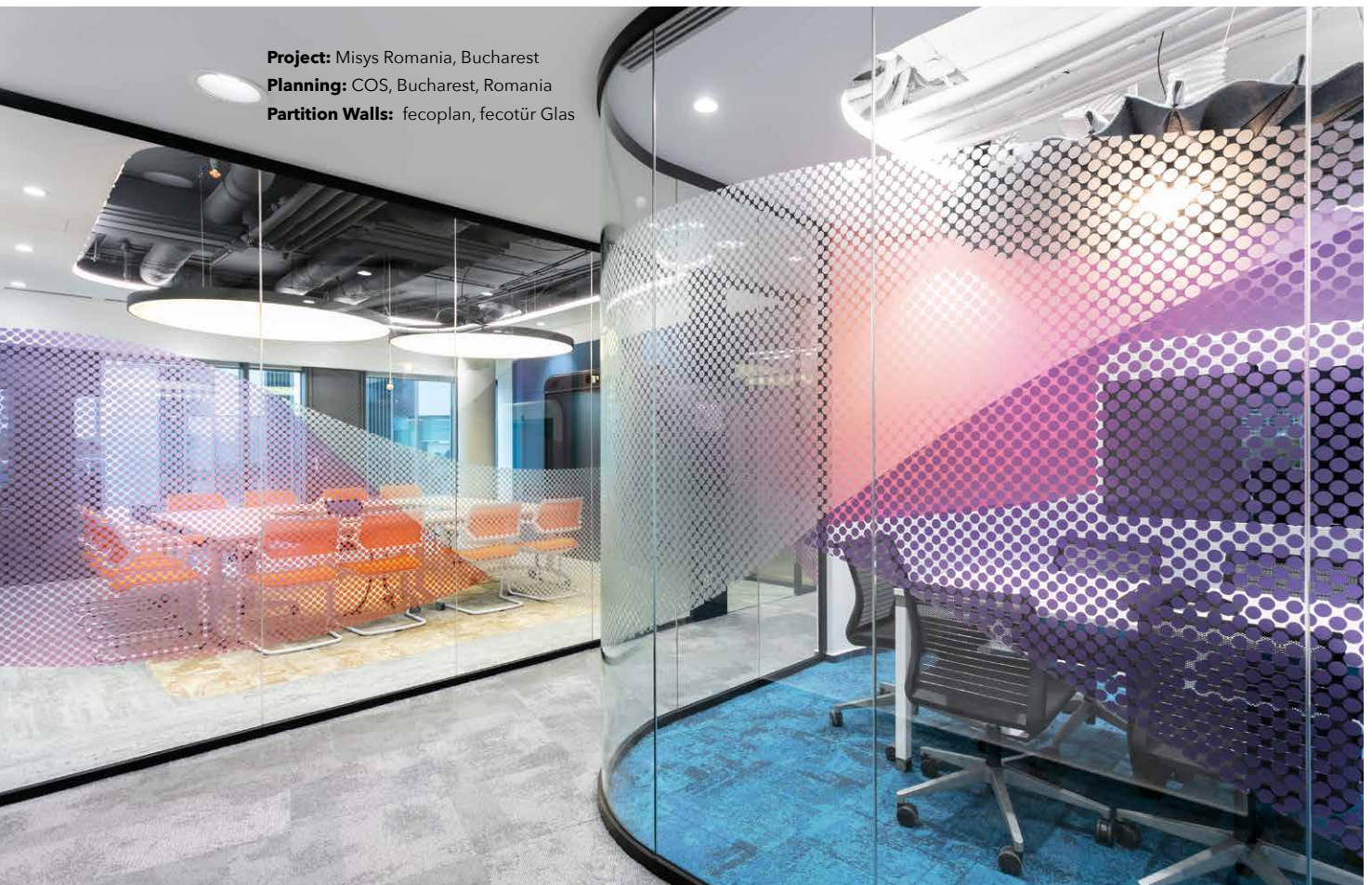

feco partnership.

The advantages for you.

The choice is yours

With the feco partition wall system, you can produce partition walls entirely or partially yourself. With your ideas and technical experience, the feco partition wall system becomes your product. Partition walls become a successful addition to your product range in line with your company profile and the requirements of your customers. We supply you with all the necessary feco system profiles. You decide whether to purchase ready-to-install wall shells, glass and door elements from feco or from your local suppliers or to manufacture them yourself.

feco systems - 35 years of know-how

Benefit from feco's know-how with processing and assembly instructions, installation videos, test certificates, certificates, marketing materials, training and much more. The planning, work preparation and assembly can all be individually determined by you.

feco partner independence

Our partners work independently after being intensively trained in our partitioning wall system by us. Your task is to provide advice, take the site measurements, issue the offer, draw up the work plans including parts lists, as well as carry out installation and provide construction support. Intensive contact with feco is nevertheless necessary and desired. We want to maintain a long-term partnership with your company.

Manufacturing and distribution agreement

Initially, we conclude a partner agreement or a manufacturing and sales agreement with our partners. If you are interested, please get more information..

Partition wall training

feco partners receive free product/assembly training in the feco-forum in Karlsruhe, and if necessary, also fire protection and production training.

feco knowledge

You can access detailed documents on the design of the feco partition walls, as well as view and download detailed drawings (pdf/dwg), planning and marketing documentation. In the protected partner area of our website (www.feco-systeme.de) you have access to comprehensive processing and assembly instructions, assembly videos, test certificates, certificates for sound insulation, fire protection and statics around the clock, and much more.

Partition wall calculation program

We provide you with our feco partition wall calculation program to aid and simplify calculation for you. This allows you to quickly and efficiently calculate your feco purchase prices (recommended price calculation).

Prospective feco clients

When they become known to us, we will send you the contact details of prospective feco clients in your sales area who contact us directly.

feco system partition walls have contributed to DGNB and LEED sustainability certification in numerous projects.



Project: Deutsche Börse AG, Eschborn
Certificate: LEED platinum



Project: Frankfurt School of Finance & Management
Certificate: DGNB platin



Share feco know-how.

Living a successful partnership.



"Partition systems are a fast-growing business segment in the US. The feco partnership gives us the opportunity to build up an important branch of our business."

Larry Hole, Pannello

Pannello, Rhode Island, USA

feco partner since 2015

Rhode Island-based Pannello supports architects, designers and interior-design specialists with office planning and partition wall projects. Many of its clients are among the top 500 companies in the US. In 2015, the company sought a long-term partnership with a leading partition wall manufacturer and has been working with feco ever since. Thanks to the licensing model, Pannello can benefit directly from more than 35 years of feco know-how and is supported through the provision of training and consultancy advice, with discussions concerning technical, administrative, commercial and logistical issues taking place several times each week. In addition, the company buys a large percentage of the materials locally. Together, these two aspects make its service in the American market efficient and competitive.



"feco always delivers on time and the products are exceptionally good. We have an excellent relationship with our contacts and the Feederle family. We believe in the company, its values and its integrity."



"With its high-quality products and as a family-run traditional company, feco fits in very well with S + W's portfolio. With feco partition walls, we can work on projects holistically and are involved in projects much earlier than with mere furnishing."

Tobias Kießling, S+W BüroRaumkultur



S+W BüroRaumkultur, Munich, Germany

feco partner since 2010

As a specialist retailer for office and property furnishings, S + W BüroRaumkultur sees itself as a partner for individual office design. Its services are wide-ranging and focused on the creation of unique office worlds for well-being and efficient and ergonomic work. Partition walls form a key part of room structures for S + W and significantly influence the overall concept in terms of transparency, sound insulation, acoustics and flexibility.

"With feco partition walls, we're able to create spaces to meet the most diverse requirements – from closed server rooms with fire protection requirements and traditional office spaces to representative conference rooms."



"We believe that feco's quality of products and services contribute to the company's first-class image in the Romanian market."

Stefan Olaru, COS

COS, Bucharest, Romania

feco partner since 2013

COS is the leading specialist for the planning and equipping of workstations and the realisation of office furnishings with quality brands. Very often it installs partition wall systems made of glass, for which the company offers comprehensive services. Over the past 20 years, COS has implemented over 10,000 projects in 1,800 companies. Today, 100 employees work for the office designer. The company's partnership with feco started in 2013 with a project for a renowned law firm, and continues to this day with complex and demanding tasks. feco provides consulting services and training to its Romanian partner and holds regular discussions with it – including at the feco-forum and the company's production sites in Karlsruhe.



"Whenever we're confronted with complex requirements, we contact feco and always receive quick and comprehensive answers from the feco team."

We are at your service.

The feco Partition Wall Systems Team.

As a leading manufacturer of partition walls made of glass and wood and a renowned office fitter, we want to connect and inspire people. In our medium-sized family business in the technology region of Karlsruhe, 120 employees work hand in hand – from the initial idea right through to assembly.

Experience and an awareness of values form the basis for meeting new challenges. We are convinced that responsible planning and production must be suited for the long term. This principle is the basis of our family business.



f.l.t.r.: Sturmius Neubeck (sales), Caroline Müller (order processing), Roland Janzer (order processing), Michael Wagner (order processing), Klaus-Michael Feederle (Managing Director)

feco Systeme GmbH

Am Storrenacker 22
D-76139 Karlsruhe
Germany

Phone: +49 721 6289-0
E-mail: mail@feco.de
Website: www.feco.de